

MOTORCYCLE

3/8"sq. MOTORCYCLE MAINTENANCE TOOL SET [14pcs.]

3/8" sq. 14 pcs. POWERFIT

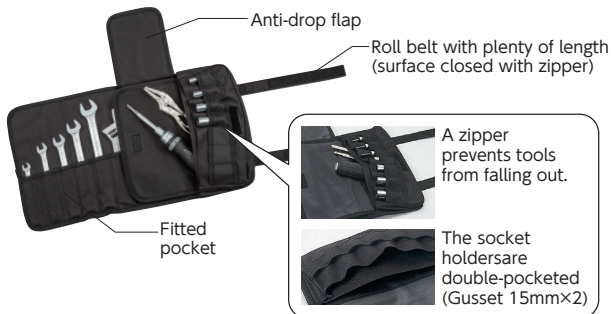

No.	Weight(kg)	⊞	
MCK3140	1.8	1	
Tool Bag (Black)			
MCKB-B	Tool bag × 1		
Contents			
3/8"sq. semi-deep socket (6pt.)	B3M-08, 10, 12, 14		
3/8"sq. slide head handle	BHM3		
3/8"sq. extension bar	BE3-150		
Combination wrenches	MS2-08, 10, 12, 14, 17		
Ratchet screwdriver	DBR14 Cross No.1 × Flat 5.5mm, Cross No.3 × Flat 8mm, Torx T15 × T20, Torx T25 × T30, Hexagon 2.5mm × 3mm, Hexagon 4mm × 5mm, cross No.2 × Flat 6mm (2pcs.)		
Locking Pliers	100LN		
Adjustable wrench	WMA-200		

- The socket facilitates work on recessed areas that cannot be handled by open end wrenches, Box end wrenches, etc.
 - The drive tool has a sliding head handle and extension bar for ease of operation.
 - The tool bag is a roll type that fits compactly when carried.
 - A zipper prevents tools from falling out.
 - The tool bag can be expanded to replace a parts or tool tray.
 - Two-tiered pockets provide space for storing items other than the set. Convenient for storing additional tools and spare parts.
- * The size when folded depends on how the tool is inserted and how the bag is rolled.
 ☞ Tool bag is shown on p.202.



When folded

3/8"sq. MOTORCYCLE TOOL SET [56pcs.]

3/8" sq. 56 pcs. POWERFIT

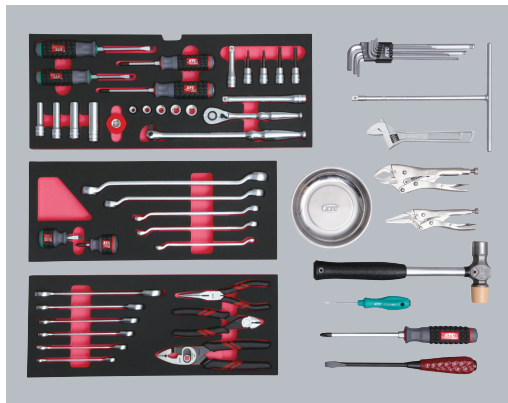

Case: SKX0213

- * The photo is example. Do not open more than one drawer at a time.
- * Surface treatment of combination pliers is plating (silver).

No.	Weight(kg)	⊞	
SK35611XMC	18	1 (2 units)	
Set contents			
SK35611XMCCT	Assembled parts × 1		
SKX0213	Chest × 1		

Contents	
3/8"sq. socket (6pt.)	B3-08, 10, 12, 13, 14
3/8"sq. deep socket (6pt.)	B3L-08, 10, 12, 14
3/8"sq. hexagonal bit socket	BT3-03, 04, 05, 06
3/8"sq. ratchet handle	BR3E
3/8"sq. breaker bar	BS3E
3/8"sq. quick spinner	BE3-Q
3/8"sq. extension bar	BE3-075, 150
Box end wrench (45° × 6° long)	M5-0810, 1113, 1214, 1719, 2224
Ratchet combination wrench	MSR1A-08, 10, 12, 13, 14, 17
Plastic grip screwdriver (Flat)	D1M2-5, 6
Plastic grip screwdriver (Cross)	D1P2-1, 2, 3
Plastic grip stubby screwdriver (Flat)	D1MS-6
Plastic grip stubby screwdriver (Cross)	D1PS-2
Split Grip Screwdriver Through Type (Flat)	FD-250
Carburetor Jet Screwdriver	CDZ-165
Combination pliers (with soft grip)	PJ-200
Adjustable wrench	WMA-200
Needle Nose Pliers	PSL-150
Nippers	PN1-150
Combination Hammer	UD7-10
Locking Pliers	150LN, 175CR
Ball Point L-Shaped Long Hex Wrench Set [9pcs.]	HL259SP(1.5, 2, 2.5, 3, 4, 5, 6, 8, 10)
3/8"sq. T-Shaped handle	TH20
Parts tray with magnet	YKPT-RM
Storage trays (3)	—

- ☞ Cases are shown on P.188.

• Do not use hand tool tools with an impact wrench.

3/8"sq. MOTORCYCLE TOOL STATION SET

3/8" sq.

80 pcs.

POWERFIT



* Surface treatment of combination pliers is plating (silver).

No.	Weight(kg)	⊞	
SK7005B	50.5	1(2 units)	

Set contents	
SK7005BT	Assembled parts × 1
SKR703A	Tool station × 1 (dial lock)

Contents	
3/8"sq. socket (6pt.)	B3-08, 10, 12, 13, 14, 17, 19
3/8"sq. deep socket (6pt.)	B3L-08, 10, 12
3/8"sq. ratchet handle	BR3E
3/8"sq. extension bar	BE3-150
3/8"sq. wobble extension bar	BE3-075JW
3/8"sq. hexagonal bit socket	BT3-04, 05, 06, 08, 10
3/8"sq. cross bit socket	BT3-2P
Box end wrench (45° × 6° long)	M5-0810, 1012, 1417, 1719, 2224
Flat type box end wrench (short)	M100-7X8, 10X12, 12X14
Open end wrench	S2-0810, 1012, 1113, 1214, 1417
Plastic grip screwdriver (Flat)	D1M2-6, 8
Plastic grip stubby screwdriver	D1P2-1, 2, 3
Split grip screwdriver through type (Flat)	FD-250
Soft grip screwdriver Flat (for carburetors)	D7SM-420
Plastic grip stubby screwdriver (Flat)	D1MS-6
Plastic grip stubby screwdriver (Cross)	D1PS-2
Baby screwdriver (Flat·Cross)	BAD-75, 0
Adjustable wrench	WMA-250
Combination pliers (with soft grip)	PJ-200
Radio pliers	PSL-150
Nippers	PN1-150
Ball and pin hammer	PH45-323
Plastic Hammer	K9-6
3/8"sq. plug wrench	B3A-16P, 18P, 20.8P
Nipple wrench	MCS2-100
For straight snap ring plier hole	SCP-171
For straight snap ring pliers shaft	SOP-171
Snap Ring Pliers Tip Claw Set	SPC5
L-Shaped ball point hex. key wrench set (Long) [9pcs.]	HL259SP(1.5, 2, 2.5, 3, 4, 5, 6, 8, 10)
T-Shaped Wrench	TH-8, 10, 12, 14
File set (5 files)	TZKF1A05(Flat, Semi-round, Round, Square, Triangular)
Brake drum screwdriver	AB-5
Tension spring tool	AB-7
Hard steel blade scraper	KZ3-18A
3/8"sq. handle	ABX101
Locking Pliers	175CR
Parts tray with magnet	YKPT-RM

☛ Cases are shown on P.194.

• Tool set for motorcycles, assembled in a tool station.
(Movable 3-tier tray type with shutters)



Case: SKR703A (Tool Station)

3/8" sq.

69 pcs.

POWERFIT



* Surface treatment of combination pliers is plating (silver).

No.	Weight(kg)	⊞	
SK6001B	39.5	1(2 units)	

Set contents	
SK6006BTA	Assembled parts × 1
SKR602A	Tool station × 1

Contents	
3/8"sq. socket (6pt.)	B3-08, 10, 12, 13, 14, 17, 19
3/8"sq. deep socket (6pt.)	B3L-08, 10, 12
3/8"sq. ratchet handle	BR3E
3/8"sq. extension bar	BE3-150
3/8"sq. wobble extension bar	BE3-075JW
3/8"sq. hexagonal bit socket	BT3-04, 05, 06, 08, 10
3/8"sq. cross bit socket	BT3-2P
Box end wrench (45° × 6° long)	M5-0810, 1012, 1417, 1719, 2224
Open end wrench	S2-0810, 1012, 1113, 1214, 1417
Plastic grip screwdriver (Flat)	D1M2-6, 8
Plastic grip stubby screwdriver	D1P2-1, 2, 3
Split grip screwdriver through type (Flat)	FD-250
Soft Fine Shaft Screwdriver Flat (for carburetors)	D7SM-420
Plastic grip stubby screwdriver (Flat)	D1MS-6
Plastic grip stubby screwdriver (Cross)	D1PS-2
Baby screwdriver (Flat·Cross)	BAD-75, 0
Adjustable wrench	WMA-250
Combination pliers (with soft grip)	PJ-200
Radio pliers	PSL-150
Nippers	PN1-150
Ball and pin hammer	PH45-323
Plastic Hammer	K9-6
3/8"sq. plug wrench	B3A-16P, 18P, 20.8P
Nipple wrench	MCS2-100
For straight snap ring plier hole	SCP-171
For straight snap ring pliers shaft	SOP-171
Snap Ring Pliers Tip Claw Set	SPC5
L-Shaped ball point hex. key wrench set (Long) [9pcs.]	HL259SP(1.5, 2, 2.5, 3, 4, 5, 6, 8, 10)
T-Shaped Wrench	TH-8, 10, 12, 14
File, half round, medium grain	FIS-100HM
3/8"sq. handle	ABX101
Locking Pliers	175CR

☛ Cases are shown on p.194.

• Tool set for motorcycles, assembled in a tool station.
(Movable 2-tier tray type)



Case: SKR602A (Tool Station)

* The photo is example. Do not open multiple drawers at the same time.

• Function mark is indicated under the product name. For the details, please refer to ☛ P.004-005.
• Products marked with ⚡ should be ordered after checking stock.

3/8" sq.

36 pcs.

Repair

Spare parts

DRIVE CHAIN TOOL SET [14pcs.]

14 pcs.

Repair Spare parts

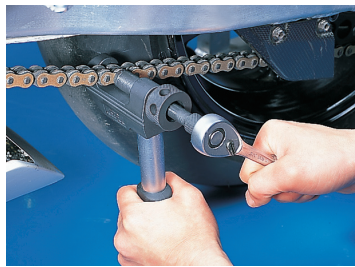

* The 3/8"sq. ratchet handle in the photo is not included in the set.

No.	Weight(kg)	□	
MCCU14	2.2	1	

Set contents	
Main body	
Outer bolt	MCCU-BA
Inner bolt	MCCU-BB
Handle	MCCU-H
For cutter pin 4050	MCCU-CA
For cut guide 4050	MCCU-CG
For cutter pin 60	MCCU-CB
For press-fit plate 40	MCCU-PA
For press-fit plate 52	MCCU-PB
For press-fit plate 50	MCCU-PC
For press-fit plate 60	MCCU-PD
Press-fit caulking receival plate	MCCU-PT
Caulking pin	MCCU-KA
Single door metal case	EKB-1 (W275×D150×H50)

- Motorcycle drive chain replacement.
- For removing chain pin, pressfitting joint plates (including type), and caulking joint pins.
- Chain sizes: 420, 428, 520, 525, 50 (530), 532, 630 and 632 chains.
- Can be used for most domestic car models.
- The main body is designed in an optimal shape based on strength analysis to achieve a sturdiness and lightness that satisfies professionals.
- Highly durable cutter pin & caulk pin is made from heat-treated special steel (SK type).
- The components are designed with the work flow in mind.
- Bolt removal is not required as cutter pins can be replaced from the front of the inner bolt.
- The cutter pins for the frequently used 40 and 50 series are the same.
- The plate can be used as a caulking support plate, which is common to all sizes, for smooth operation.
- Since the same outer bolt is used to press-fit and crimp the plate, there is no need to set the inner bolt again after removing the joint pin.
- The grip and handle are shaped for easy application of force.
- * A drive tool such as a separate 3/8"sq. ratchet tool is required when using this tool.

Spare parts

No.	Description	□	
MCCU-BA	Outer bolt	1	
MCCU-BB	Inner bolt	1	
MCCU-H	Handle	1	
MCCU-CA	For cutter pin 4050	1	
MCCU-CG	For cut guide 4050	1	
MCCU-CB	For cutter pin 60	1	
MCCU-PA	For press-fit plate 40	1	
MCCU-PB	For press-fit plate 52	1	
MCCU-PC	For press-fit plate 50	1	
MCCU-PD	For press-fit plate 60	1	
MCCU-PT	Press-fit caulking receival plate	1	
MCCU-KA	Caulking pin	1	

* Components are not compatible with previous products (CAU13, CAU11).

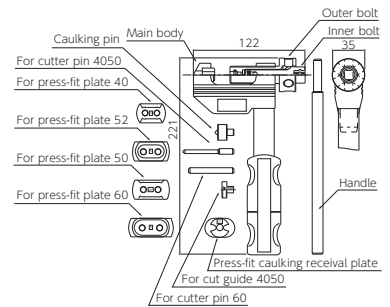

VALVE SPRING COMPRESSOR

Repair
Spare parts



No.	Weight(kg)	☐	
MCVU5	1.4	1	
Set contents			
Main body			
Attachment φ 16.5	MCVU-A16		
Attachment φ 20	MCVU-A20		
Attachment φ 24	MCVU-A24		
Attachment φ 28	MCVU-A28		

- Maintenance of intake and exhaust valves of 4-stroke engines (removal and installation of valve springs).
- Four sizes of attachments (φ 16.5, 20, 24, 28) are available for most car models.
- The attachment can be replaced with one-touch operation, and the wide opening allows smooth removal of the valve cotter.

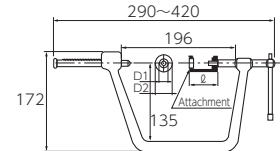

Spare parts

No.	Description	D1	D2	ℓ	☐	
MCVU-A16	Attachment φ 16.5	17	19	50	1	
MCVU-A20	Attachment φ 20	20	22	50	1	
MCVU-A24	Attachment φ 24	24	26	50	1	
MCVU-A28	Attachment φ 28	28	31	50	1	

* The attachment can also be used with the conventional valve spring compressor (VSU4).

20.8mm SPARK PLUG WRENCH (SHORT TYPE)



No.	S	D1	D2	L	Weight(g)	☐	
MCPS-20.8	20.8	34	32	170	176	5	

- Replacement of water-cooled 2-stroke spark plugs (20.8 mm). (Can also be used for 20.6mm)
- The overall length is 170 mm, making it short and easy to use.
- This is useful for cars where the top of the spark plug is too narrow to use a socket-type plug wrench.

Open end wrench: The bore is angled at 15° and can be used both front and back, and can be turned at an angle of 30°.

Glasses: Can be used by wrenching on the hexagonal part avoiding the plug guiding part, such as the underside of the tank.

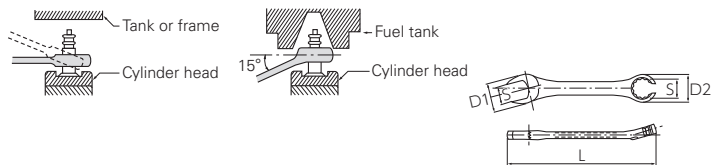

NIPPLE WRENCH



No.	D1	A	B	C	D	E	F	T	L	Weight(g)	☐	
MCS2-100	20	4.5	5.1	5.8	6.1	6.4	6.6	10	100	80	5	

- Tightening, adjustment, and inspection of spoke nipples on motorcycle wheels.
- One wrench can be used for 6 sizes (4.5, 5.1, 5.8, 6.1, 6.4, 6.6) and can be applied to most vehicles.
- Compact and lightweight, convenient for inspection, touring, and racing.
- The forged products are excellent in durability due to appropriate heat treatment.
- The wrench is 10 mm thick and holds the entire nipple face width to prevent damage.

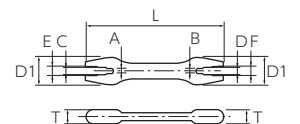

TIRE VALVE WRENCH



No.	a	b	D	ℓ	L	Weight(g)	☐	
MVC-30	2.2	4.5	29	15	35	20	1	

- The compact size of 35 mm in overall length allows use in car models where the conventional long type could not be used.
- It is indispensable for puncture repair and tire/tube replacement.

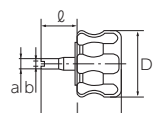

• Function mark is indicated under the product name. For the details, please refer to P.004-005.
• Products marked with should be ordered after checking stock.

3/8" sq.

36 pcs.

Repair
Spare parts

TIRE LEVER



No.	B	W	L	∅	Weight(g)	⊞
MCOL-260	23	30	263	70	170	5

- The thin tip and smooth finish make it easy to insert between the rim and side bead for smooth operation.
- The product is heat-treated appropriately to ensure excellent durability.
- The grip is made of oil-resistant rubber and is shaped for a good grip, making it easy to apply force.

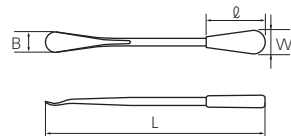

TIRE LEVER



No.	A	W	T	L	Weight(g)	⊞
OHZ-210	7	22	5.5	210	100	1

- The overall length is 210mm, making it easy to carry when touring.
- The forged products are excellent in durability due to appropriate heat treatment.

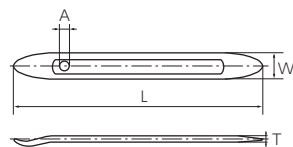

TENSION SPRING TOOL



No.	L	Weight(g)	⊞
AB-7	153	90	1

- Removal of drum brake tension spring.
- A tip that prevents the spring from coming off and a T-shaped handle that makes it easy to apply force ensure safe operation.

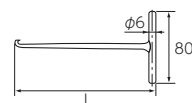

WIRE TWISTER



No.	Applicable wire diameter	L	B	T	⊞	Weight(g)
WTP-215	∅ 1	215	16.3	10.8	1	290

- Tool for wiring of bolts and nuts.
- It can also be used for fixing with wire when producing rebar in concrete foundations.
- Compatible with wires up to ∅ 1.
- Stainless steel and brass are both available.
- The lock mechanism has a perforated non-slip surface for easy application of force.
- * The direction of rotation is clockwise.



Condition of use

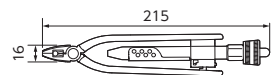

Related Items



Tool bag
➔ P.202



T-SHAPED Wrench
➔ P.349



1/2"sq. stud bolt remover
➔ P.250



Interchangeable screwdriver set
➔ P.360

• Do not use hand tool tools with an impact wrench.