

CONSTRUCTION AND FACILITY

CONSTRUCTION AND FACILITY 458

PLUMBING TOOLS 463

**CONSTRUCTION AND
FACILITY**

**CONSTRUCTION AND
FACILITY**

Tightening from M16 to M24 with a single unit

Supports Torshear bolts M16 to M24 by simply replacing the outer/inner sockets.

A single Torshear wrench can be used in a wide range of sites. In addition, the cordless type provides a stable power supply and mobility.

On full charge
M22 : 350 pcs.
M24 : 250 pcs.
can work.

Cordless design
ensures stable
power supply
and high
workability



CORDLESS TORCIA WRENCH SET



With special resin case (W516×D458×H160)

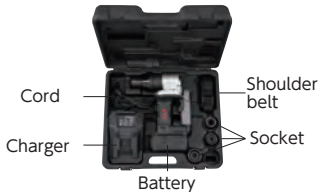

JAE951 (Main body)



No.	No-load RPM (rpm)	Lithium-ion battery	Applicable Bolts	Weight (kg)
JTAE951	0~15	36V/6.0Ah	M16,M20,M22,M24	7.8

[Set contents]

Main unit (JAE951)×1, battery (JBE36060)×1, charger (JHE360)×1, power cord×1,

Inner socket: M16/M20/M22/M24×1 each,

Outer socket: M16/M20/M22/M24×1 each,

Shoulder belt×1, dedicated plastic case (W516×D458×H160)×1

Usage · Tightening of Torshear bolts (shear bolts) used in building construction/assembly of steel structures such as bridges.

Feature · Applicable for Torshear bolts M16 to M24.

- Applicable for all Torshear bolts by simply replacing the outer/inner sockets.
- M22 and M24 can be used for more than 350 and 250 pcs with full charge.
- 90°×4-step swivel mechanism (bolt-fixing type).
- The counter function allows the number of bolts tightened to be checked.
- Brushless motors are used for longer service life.



A 90°×4-step swivel mechanism is included, enabling the machine to be used for lifting work.



Equipped with a counter function to check the number of bolts tightened.

Cordless torcia wrench (main body)

No.

JAE951

* This is the main unit only. Battery, battery charger, power cord, shoulder belt, and special plastic case are not included.

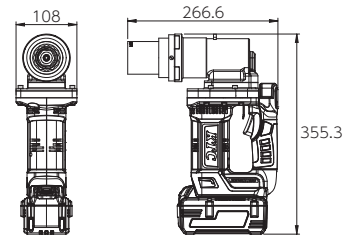

Spare parts

No.	Description	☐
JAE951-3	M16 Outer Socket	1
JAE951-49	M20 Outer Socket	1
JAE951-51	M22 Outer Socket	1
JAE951-53	M24 Outer Socket	1
JAE951-4	M16 Inner Socket	1
JAE951-50	M20 Inner Socket	1
JAE951-52	M22 Inner Socket	1
JAE951-54	M24 Inner Socket	1

No.	Description	☐
JBE36060	Battery pack	1
JHE360	Lithium-ion dedicated charger	1

No.	Description	☐
JAE951-5	Spring	1
JAE951-6	Release pin	1
JAE951-7	Release pin spring	1
JAE951-8	Release pin socket	1

· Function mark is indicated under the product name. For the details, please refer to P.004-005.
· Products marked with should be ordered after checking stock.



Can be used for heavy-duty vehicles (trucks and buses) as well as agricultural and construction machinery

Labor-saving tightening of bolts and nuts for large vehicles (trucks and buses) and agricultural and construction equipment.

Compact, portable, and high-power cordless electric torque wrenches reduce the work load, improve workability, and contribute to labor savings.

HYTORC

HYTORC is a U.S. manufacturer of industrial bolt tightening tools, and since its establishment in 1968, has expanded its business to more than 80 countries around the world. HYTORC boasts a 70% share of the world market for its main product, the hydraulic torque wrench, which is used in a variety of industries in Japan.

1.Labor saving	2.Safety	3.Powerful and high functionality
<p>【Issues】</p> <ul style="list-style-type: none"> •Want to carry the tools easily. •Need sole operation <p style="text-align: center;">▼</p> <p>Compact size, 275 mm high × 88 mm wide. Easy to carry to the maintenance site and work by one person.</p>	<p>【Issues】</p> <ul style="list-style-type: none"> •Avoid loud noises. •Avoid to damage bolts and nuts. <p style="text-align: center;">▼</p> <p>Quiet and vibration-free at approximately 60 dB. Less recoil and no risk of damaging bolts and nuts.</p>	<p>【Issues】</p> <ul style="list-style-type: none"> •No power tools to tighten bolts and nuts on large vehicles and agricultural and construction equipment. <p style="text-align: center;">▼</p> <p>High power with maximum torque of 949 N·m that enables tightening of large vehicles. Adjustable torque value in 1 N·m increments.</p>

ELECTRIC TORQUE WRENCH

3/4" sq.

MAX Torque 949N·m

3.7Kg Main body+Battery

18V Li-ion

Repair Spare parts

Repairable



No.	Torque range N·m	Lithium-ion battery	Over-all length (mm)	Height (mm)	Width (mm)	Weight (kg)	□
LION-700	94~949	18V	274	275	88	3.7	1

【Set contents】

- Main unit (LION-700), 1 battery pack, 1 charger, 1 power cable, 1 dedicated plastic case
- High power with maximum torque of 949 N·m enables tightening of wheel nuts on large vehicles (trucks and buses).
- Torque can be adjusted in 1 N·m increments. Easy torque setting from the display.
- Measurement accuracy is ±5% and meets ISO17025.
- High-capacity 18V battery.
- * Batteries and chargers are not eligible for repair.



Adjustment in 1 N·m
Torque value can be easily set from the display and adjusted in 1 N·m increments.



High output and light weight
High power of 949 N·m and light weight of approximately 3.7 kg. Save operator's workload.



Reaction force receiver for safety
Optional reaction force receiver for safe high-torque tightening work.



Image



With special resin case

Battery
Charger
Standard reaction force receiver
Power cable

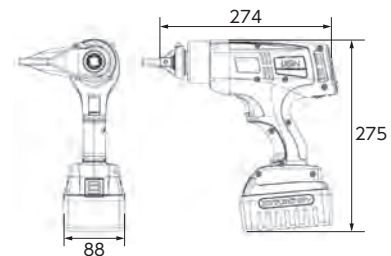

HY700-WG-EX4

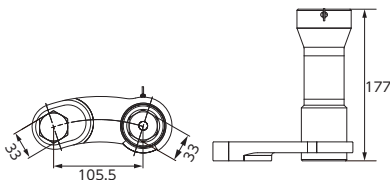

Options

No.	Description	Weight (kg)	□
HY700-WG-EX4	Reaction force jig for 33mm under ISO specification	2.4	1

- This is a reaction force receiver exclusively for the electric torque wrench (LION-700).
- Safe high-torque tightening for heavy-duty vehicle maintenance.

Spare parts

No.	Description	□
P002200-3	18V spare battery	1
A000771	Standard reaction force receiver	1
A000791	Charger	1
K000806	100V power cable	1



A000791



P002200-3



A000771

• Do not disassemble or modify the product.

Safe and highly durable! New series

Socket bit for impact driver with drop prevention function for safe working at high places. Even bit broken, the "unique mechanism" allows for smooth detachment from the impact driver.

No stuck!

The bit breaks off inside the socket, so no bit fragments remain inside the chuck, and even if damaged, the bit can be smoothly detached from the impact driver.

Check out the video



No fallout!

Unique mechanism is used for the bit. Prevents the tip (socket) from falling even if damaged. No special anti-drop equipment is required, and one-touch attachment is possible.

High durability!

The socket is a unique mechanism that has a torsion effect with a longer internal bit section, achieving high durability!



SOCKET BIT SET FOR IMPACT DRIVER [5pcs.]

1/4" 6.35 5 pcs.



POWERFIT



No.	Weight(g)	⊖
TBZP635	1,040	1

Set contents

Socket Bits for Impact Driver BZP63-17, 19, 21, 22, 24

Case (outer dimension: l200×w153×h40, inner dimension: l190×w120×h33)

- This is a set of socket bits with a large diameter recommended for fastening steel frames, etc.
- The free space in the case can be used to store bits, etc.
- * No stand-alone cases are available.

SOCKET BIT SET FOR IMPACT DRIVER [7pcs.]

1/4" 6.35 7 pcs.



POWERFIT



No.	Weight(g)	⊖
TBZP637	980	1

Set contents

Socket Bits for Impact Driver BZP63-10, 12, 13, 14, 17, 19, 21

Case (outer dimension: l200×w153×h40, inner dimension: l190×w120×h33)

- A set of socket bits with a small bore size recommended for light-duty work.
- * No stand-alone cases are available.

SOCKET BIT FOR IMPACT DRIVER

1/4" 6.35



POWERFIT



No.	S	D1	D2	H	L	Weight(g)	⊖
BZP63A-17	17	24	18	18.5	115	123	5
BZP63A-19	19	26	20	20.5	115	126	5
BZP63A-21	21	28.5	22	22.5	115	141	5

- This is a high durability model Applicable for 40V.

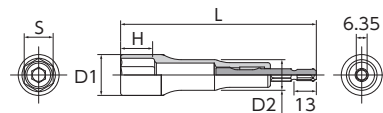

FLEXIBLE SOCKET BIT FOR IMPACT DRIVER

1/4" 6.35



No.	S	D1	D2	H	L	Weight(g)	⊖
BZP63AF-17	17	23	20	17	123	143	5
BZP63AF-19	19	25	21	19	123	152	5
BZP63AF-21	21	28	22	19	123	167	5

- This is a high durability model Applicable for 40V.
- The 15° swivel enables tightening near walls and corners that are difficult for impact drivers to reach.

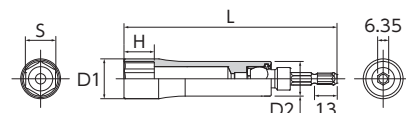
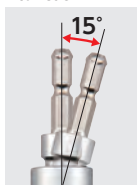

• Function mark is indicated under the product name. For the details, please refer to P.004-005.
• Products marked with should be ordered after checking stock.



SOCKET BIT FOR IMPACT DRIVER(SHORT)



No.	S	D1	D2	H	L	Weight(g)	⊖
BZP63S-10	10	16	14.5	11	70	54	5
BZP63S-12	12	18	15	13	70	59	5
BZP63S-13	13	18.5	16	14	70	63	5
BZP63S-14	14	20	17	17	70	69	5
BZP63S-17	17	24	18	18.5	76	97	5
BZP63S-19	19	26	20	20.5	76	109	5
BZP63S-21	21	28.5	22	22.5	78	128	5
BZP63S-22	22	30	23	23	78	144	5
BZP63S-24	24	32.5	26	27	81	182	5

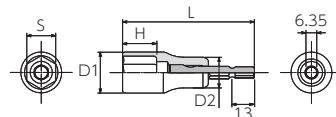

SOCKET BIT FOR IMPACT DRIVER



No.	S	D1	D2	H	L	Weight(g)	⊖
BZP63-10	10	16	14.5	11	97	74	5
BZP63-12	12	18	15	13	97	76	5
BZP63-13	13	18.5	16	14	97	85	5
BZP63-14	14	20	17	17	97	93	5
BZP63-17	17	24	18	18.5	101	123	5
BZP63-19	19	26	20	20.5	101	140	5
BZP63-21	21	28.5	22	22.5	101	151	5
BZP63-22	22	30	23	23	101	173	5
BZP63-24	24	32.5	26	27	101	210	5

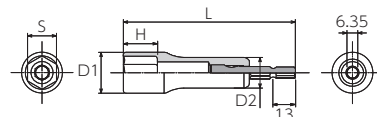

SOCKET BIT FOR IMPACT DRIVER



No.	S	D1	D2	H	L	Weight(g)	⊖
BZP63-17W	17	24	18	18.5	101	121	5
BZP63-19W	19	26	20	20.5	101	135	5
BZP63-21W	21	28.5	22	22.5	101	146	5

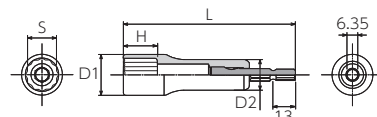

SOCKET BIT FOR IMPACT DRIVER(LONG)



No.	S	D1	D2	H	L	Weight(g)	⊖
BZP63L-17	17	24	18	18.5	151	156	5
BZP63L-19	19	26	20	20.5	151	175	5
BZP63L-21	21	28.5	22	22.5	151	200	5
BZP63L-24	24	32.5	26	27	151	282	5

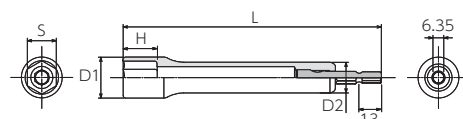

· Do not disassemble or modify the product.



CAUTION

- Always read the "Instruction Manual" before use.
- Do not use for cutting other than applicable pipes.
- Do not use if cracks, chips, wear, deformation, or other abnormalities are found.
- Do not modify. Do not heat or process the product as this may cause a significant deterioration in quality.

Ratchet pipe cutter

Purpose: Cutting of various piping from water supply for waterworks. (Electricity, gas, etc.)

Feature: Ratchet mechanism allows easy and fast cutting even in tight spaces.

Comparison of usage conditions

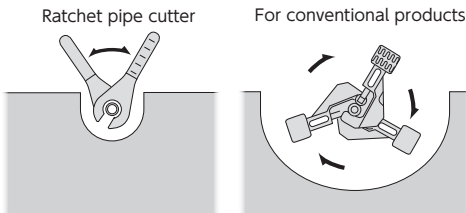

Easy cutting even in tight spaces



Special thin blade prevents chips, sparks, and burrs, and is applicable to a wide range of pipes.

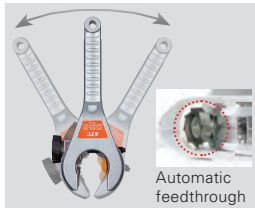

The "automatic feed mechanism" eliminates the need for troublesome feeding operations.

The cutter maintains a constant feed rate (force) by an automatic feed mechanism and does not apply excessive force.
Automatic feed mechanism and special blades ensure clean cutting surfaces.

Includes 1 replacement blade.

Lightweight aluminum body.

Handle swing angle is 7.5° for cutting. This is effective for cutting in tight spaces.

Wide range of applicable pipes.



The ratchet mechanism and rotary head make it easy to work in tight spaces.

Replacement blade: A dedicated replacement blade is required depending on the applicable pipe. The replacement blades are color-coded for easy identification. P.465



PCRK-FS
For steel and stainless steel pipes (Orange)



PCRK-S
For stainless steel pipe (Gold)



PCRK-C
For copper and plastic pipes (Green)



Features

List of pipe cutter types and applications

Type	Part number	Application	Copper pipe	Carbon Steel Pipes for Piping	Conduit	Stainless steel pipes for general piping	Stainless Steel Pipes for Piping	Stainless steel flexible pipe	Resin pipe		
									Rigid PVC pipes for water supply	Polyethylene pipes for water supply	Polyethylene pipes for gas
Ratchet pipe cutter	PCR3-35 Ratchet Pipe Cutter	Size Applicable pipe thickness		10A~25A Max. 3.2mm		13Su~30Su Max. 1.2mm	10A~25A Max. 3mm				
	PCR3-66 Ratchet Pipe Cutter (Large)	Size Applicable pipe thickness		25A~50A Max. 3.8mm	G36~G54 C39~C63 Max. G54:2.8mm Max. C63:2mm	30Su~60Su Max. 1.5mm	25A~50A Max. 3mm				
	PCRT2-35 Ratchet Pipe Cutter For Copper And Resin Pipe	Size Applicable pipe thickness	1/2"~1 1/4"	Max. 1.65mm					13~25 Max. 3.5mm	10~25 Max. 5mm	20~25 Max. 3.4mm
	PCRT2-66 Ratchet Pipe Cutter For Copper And Resin Pipe (Large)	Size Applicable pipe thickness	1 1/4"~2 1/2"	Max. 2.03mm					30~50 Max. 4.5mm	25~50 Max. 6.5mm	25~50 Max. 5.5mm
	PCRT-23 Ratchet Tube Cutter For Copper (Mini)	Size Coated copper tube Applicable pipe thickness	1/4"~7/8" 1/4"~1/2"	Max. 1.24mm							
Rotary Pipe Cutter	PC2-66 Tube Cutter	Size Applicable pipe thickness	1/4"~2 1/4"			8Su~60Su Max. 1.5mm			13~50 Max. 4.5mm		
	ZC30 Tube Cutter	Size Applicable pipe thickness	1/4"~1"						13~20 Max. 3mm	10~20 Max. 3mm	15~20 Max. 3mm
	FV20 Flexible Tube Cutter	Size Applicable pipe thickness						1/2"~3/4" Max. 0.3mm			

• A replacement blade other than the one supplied with the main unit may be required.

• Do not hit or extend it with a pipe or other tools.

RATCHET PIPE CUTTER

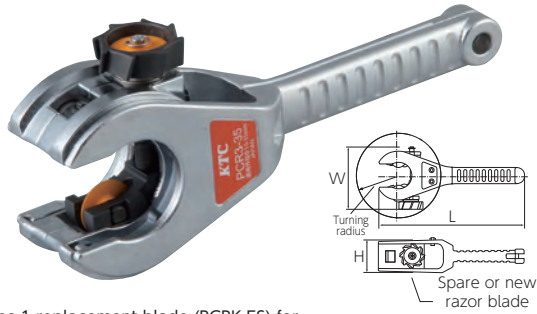

- * Includes 1 replacement blade (PCRK-FS) for steel pipe and stainless steel pipe.
- * The blades are shipped with the paint peeling off in order to perform cutting tests.



- Even if a replacement blade for stainless steel pipe (PCRK-S) is attached to PCR3-35 and PCR3-66, stainless steel pipe (thick-walled pipe over 1.5 mm) cannot be cut.
- The PCRK-FS replacement blade cannot be used with ratchet pipe cutters other than the PCR3 series.

No.	L	W	Turning radius	H	Weight(g)
PCR3-35	240	102	70	54	960

- Capable of cutting stainless steel pipes up to 3.0 mm thick for thick-walled piping used in plant facilities.
- By replacing the blade for stainless steel pipe (No.PCRK-S: sold separately), it is possible to cut stainless steel pipe (thin-walled pipe) with a thickness of 1.5 mm or less. For details, see "Ratchet Pipe Cutter (PCR3-35, PCR3-66) Application List".
- * Repair parts are set. Refer to "Repairable List" from P.625.

Applicable blade

No.	Contents	Weight(g)
PCRK-FS	For steel and stainless steel pipes	One pc 7
PCRK-S	For stainless steel pipe	One pc 16

Applicable Outer Diameter
15.88~35mm

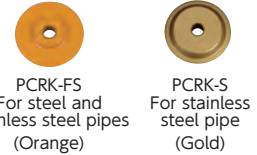
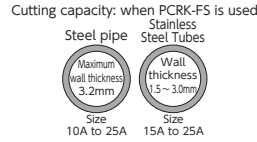

RATCHET PIPE CUTTER (LARGE)

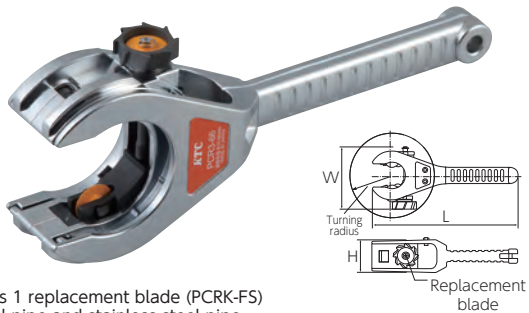

- * Includes 1 replacement blade (PCRK-FS) for steel pipe and stainless steel pipe.
- * The blades are shipped with the paint peeling off for pre-shipment inspections.



- Even if a replacement blade for stainless steel pipe (PCRK-S) is attached to PCR3-35 and PCR3-66, stainless steel pipe (thick-walled pipe over 1.5 mm) cannot be cut.
- The PCRK-FS replacement blade cannot be used with ratchet pipe cutters other than the PCR3 series.

No.	L	W	Turning radius	H	Weight(g)
PCR3-66	335	135	90	62	1,750

- Capable of cutting stainless steel pipes up to 3.0 mm thick for thick-walled piping used in plant facilities.
- By replacing the blade for stainless steel pipe (No.PCRK-S: sold separately), it is possible to cut stainless steel pipe (thin-walled pipe) with a thickness of 1.5 mm or less. For details, see "Ratchet Pipe Cutter (PCR3-35, PCR3-66) Application List".
- * Repair parts are set. Refer to "Repairable List" from P.625.

Applicable blade

No.	Contents	Weight(g)
PCRK-FS	For steel and stainless steel pipes	One pc 7
PCRK-S	For stainless steel pipe	One pc 16

Applicable Outer Diameter
35~66mm

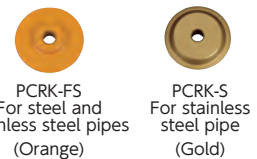
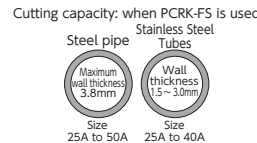

Ratchet pipe cutter (PCR3-35,PCR3-66) application list

Tube type	Type	Carbon Steel Pipes for Piping			Conduit			Stainless steel pipes for general piping		Stainless Steel Pipes for Piping		
		Mark	SGP		JIS C 8305			SUSTPD		SUS304TP		
No.	Specification	JIS G 3452					JIS G 3448		JIS G 3459			
	Size	10A ~ 25A ~ 50A	G36 G42 G54	C39 C51 C63	13Su ~ 30Su ~ 60Su	10A ~ 25A ~ 50A	10A ~ 25A ~ 50A	10A ~ 25A ~ 40A				
	Outer diameter	3/8B ~ 1B ~ 2B	41.9 47.8 59.6 38.1	50.8 63.5	15.88 ~ 34.0 ~ 60.5	17.3 ~ 34.0 ~ 60.5	17.3 ~ 34.0 ~ 60.5	17.3 ~ 34.0 ~ 48.6				
	Thickness	2.3 ~ 3.2 ~ 3.8	2.5 2.5 2.8 1.6 1.6 2.0	0.8 ~ 1.2 ~ 1.5	1.2 ~ 1.65 ~ 1.65	1.65 ~ 2.8 ~ 2.8	2.0 ~ 3.0 ~ 3.0					
Remarks					Sch5S	Sch10S	Sch20S					
PCR3-35 Applicable outer diameter 15.88 ~ 35mm	Steel pipe	PCRK-FS						* 1: Please use PCRK-S.				
	Stainless Steel Tubes				PCRK-S	PCRK-FS	PCRK-FS	PCRK-FS				
PCR3-66 Applicable outer diameter 35 ~ 66mm	Steel pipe	PCRK-FS										
	Stainless Steel Tubes				PCRK-S	PCRK-FS	PCRK-FS	PCRK-FS				
	Conduit		PCRK-FS									



- Even if a replacement blade for stainless steel pipe (PCRK-S) is attached to PCR3-35 and PCR3-66, stainless steel pipe (thick-walled pipe over 1.5 mm) cannot be cut.
- The PCRK-FS replacement blade cannot be used with ratchet pipe cutters other than the PCR3 series.

SPARE BLADE FOR STEEL & SUS PIPE



No.	Contents	Weight (g)	Applicable body part number					
			PCR3-35	PCR3-66	PCR2-35* 2	PCR2-66* 2	PCRT2-35	PCRT2-66
PCRK-FS* 1	For steel and stainless steel pipes	One pc 7	●	●				
PCRK-F	For steel pipe	One pc 7			●	●		
PCRK-S	For stainless steel pipe	One pc 16	●	●	●	●		
PCRK-C	For copper and plastic pipes	One pc 7					●	●

- * 1: PCRK-FS is a replacement blade exclusively for PCR3-35 and PCR3-66. It cannot be used for other ratchet pipe cutters.
- * 2: PCR2-35 and PCR2-66 are discontinued products.



• Do not use with non-applicable products.

- Function mark is indicated under the product name. For the details, please refer to P.004-005.
- Products marked with should be ordered after checking stock.



RATCHET PIPE CUTTER FOR COPPER AND RESIN PIPE

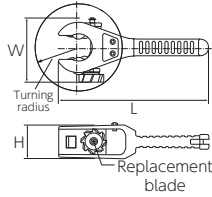
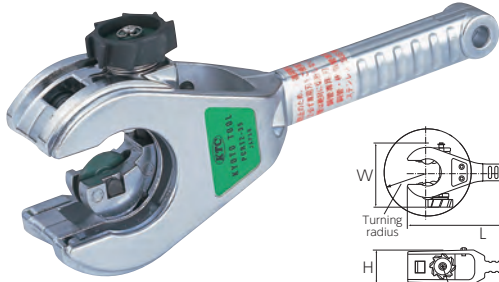

Applicable Outer Diameter
15.88~35mm

Applicable blade	Copper pipe	Rigid PVC pipes for water supply	Polyethylene pipes for water supply	Polyethylene pipes for gas
	Maximum wall thickness 1.65mm Size 1/2"~1 1/4"	Maximum wall thickness 3.5mm Size 13~25	Maximum wall thickness 5.0mm Size 10~25	Maximum wall thickness 3.4mm Size 20~25

* Includes 1 replacement blade (PCRK-C) for copper and plastic pipes.
* The blades are shipped with the paint peeling off for pre-shipment inspections.

No.	L	W	Turning radius	H	Weight(g)
PCRT2-35	240	102	70	54	960

* Cannot be used for steel pipes, stainless steel pipes, or coated copper pipes.
* Repair parts are set. Refer to "Repairable List" from P.625.

Applicable blade

No.	Contents	Weight(g)
PCRK-C	For copper and plastic pipes	7

RATCHET PIPE CUTTER FOR COPPER AND RESIN PIPE (LARGE)

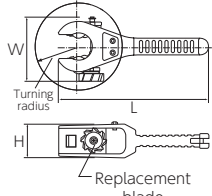
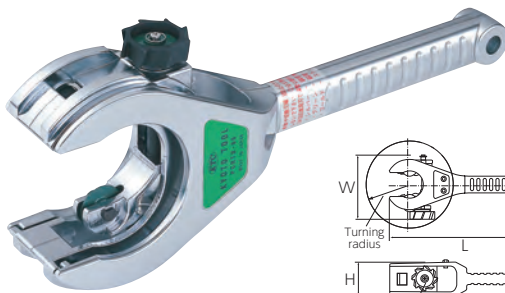

Applicable Outer Diameter
35~66mm

Applicable blade	Copper Tube	Rigid PVC pipes for water supply	Polyethylene pipes for water supply	Polyethylene pipes for gas
	Maximum wall thickness 2.03mm Size 1 1/4"~2 1/2"	Maximum wall thickness 4.5mm Size 30~50	Maximum wall thickness 6.5mm Size 25~50	Maximum wall thickness 5.5mm Size 25~50

* Includes 1 replacement blade (PCRK-C) for copper and plastic pipes.
* The blades are shipped with the paint peeling off in order to perform cutting tests.

No.	L	W	Turning radius	H	Weight(g)
PCRT2-66	335	135	90	62	1,650

* Cannot be used for steel pipes, stainless steel pipes, or coated copper pipes.
* Repair parts are set. Refer to "Repairable List" from P.625.

Applicable blade

No.	Contents	Weight(g)
PCRK-C	For copper and plastic pipes	7

RATCHET TUBE CUTTER FOR COPPER (MINI)

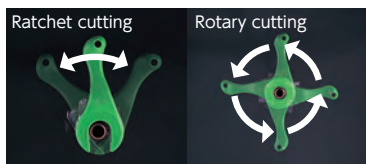

Two functions in one bottle

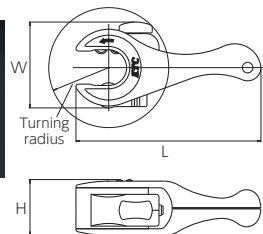

Applicable Outer Diameter
6~23mm

Applicable blade	Copper pipe	Coated copper pipe
	Maximum wall thickness 1.24mm Size 1/4"~7/8"	Maximum wall thickness 1.24mm Size 1/4"~1/2"

No.	L	W	H	Turning radius	Weight(g)
PCRT-23	140	64	42	45	180

* Cannot be used for steel and stainless steel pipes.
* Repair parts are set. Refer to "Repairable List" from P.625.

Applicable blade

No.	Contents	Weight(g)
PCRK-CM	For copper tube	3

Usage • Cutting of copper tubes for air-conditioning and bare/coated copper tubes for water supply and hot water.

Feature • The ratchet mechanism enables cutting in tight spaces such as near walls.
• Possible to cut by rotating the main unit all the way around.
• The cutter's automatic feed mechanism eliminates the need for tightening in work.
• The weight is about 2/3 of our conventional products by adopting a plastic body and an aluminum rotary head.
• Bright green body that stands out even in dark places.
• The body is made of recyclable polyamide.

Usage rules

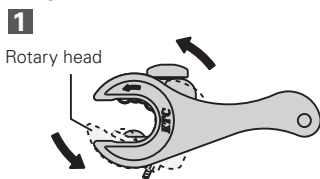

1 Turn the rotary head to align the openings of the body and rotary head.

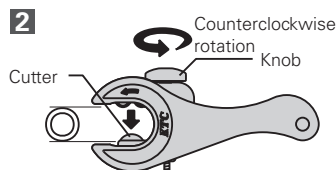

2 If the pipe does not fit into the cutter, turn the knob counterclockwise and move the cutter to the point where the pipe can be clamped.

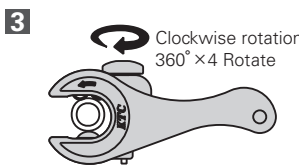

3 Turn the knob clockwise to place the cutter on the copper tube, and then tighten it about 4 more turns.

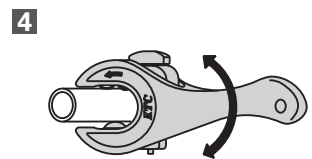

4 Cut the pipe by reciprocating or rotating the handle. The cutter can cut to the end by an automatic feed mechanism.

• Do not hit or extend it with a pipe or other tools.

TUBE CUTTER

Repair

Spare parts

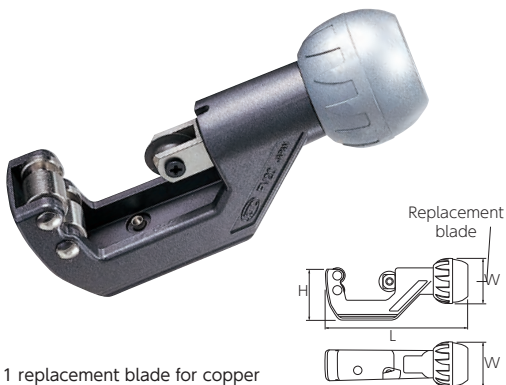

* Includes 1 replacement blade for copper and plastic pipes.

No.	L	W	H	Weight(g)	☐
ZC30	126	40	45	270	1

- Cutting of copper and plastic pipes. (Do not use for cutting stainless steel flexible pipe.)
- The rigidity against torsion has been increased and stability during cutting has been improved.
- * The main body of the product include a blade for copper and plastic pipes.
- * Repair parts are available. Please contact our distributors for details.

Applicable blade

No.	Applicable pipe	Maximum wall thickness	φ	Q'ty	Weight (g)
ZCK305	Copper tube (φ 3-30)	2.0	17	5 pcs	20
	Resin pipe (φ 3-30)	3.0			
ZCK305S	Thin-walled stainless steel pipe (φ 3-30)	1.0	17	5 pcs	21



TUBE CUTTER

Repair

Spare parts

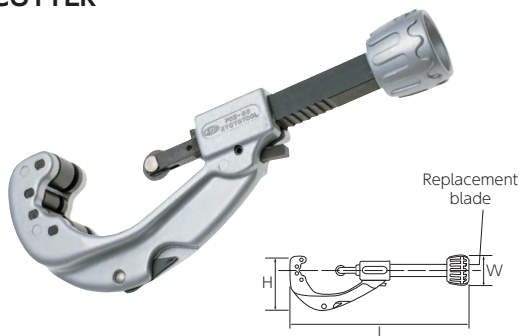

* Includes one replacement blade for copper pipe.

No.	Cutting diameter	L	W	H	Weight(g)	☐
PC2-66	φ 6~66	201~282	42	90.5	730	1

* The main body of the product is equipped with a blade for copper tubing.

Applicable blade

No.	Type	φ	Q'ty	Weight(g)
PCK305	Replacement Blades for Copper Tubing	18.5	5 pcs	15
PCK305S	Replacement blade for stainless steel pipe	18.5	5 pcs	15
PC2665C	Replacement blades for PVC and coated pipes	25.5	5 pcs	20

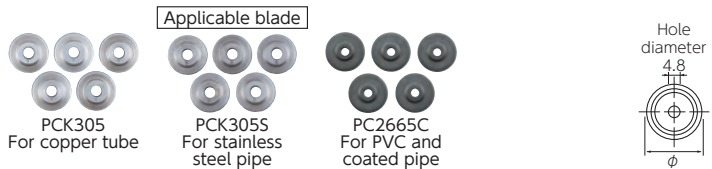

FLEX TUBE CUTTER

Repair

Spare parts

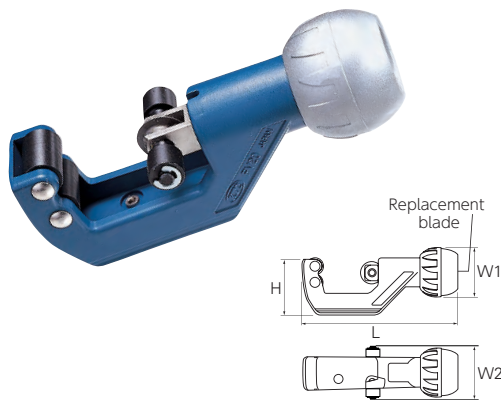

* Includes 1 replacement blade.
* Use the blade for copper and plastic tubes of the ZC30 tube cutter.

No.	L	W1	W2	H	Weight(g)	☐
FV20	126	40	42	45	220	1

- Cutting stainless steel flexible pipe. (This is for stainless steel flexible pipe only. Do not use for other purposes.)
- Stainless steel flexible pipe for gas piping : Size 8A to 20A
- Stainless steel flexible pipes for water supply and hot water : Size 13, 20 (except spiral shape)
- The use of plastic rollers and auxiliary rollers reduces pipe deformation, burrs, and peeling on the cut surface.

* Auxiliary rollers and cutter pins are available as repair parts. Please contact our distributors for details.

Applicable blade

No.	Applicable pipe	Maximum wall thickness	φ	Q'ty	Weight (g)
ZCK305	Stainless steel flexible pipe (peak diameter φ 15.8 to 21)	0.3	17	5 pcs	20



TUBING TOOL SET [3pcs.]

3 pcs.

Repair

Spare parts



No.	Weight(kg)	☐
VS31	1.8	1

- Set contents
- Tube cutter (φ 3-30) | ZC30
 - Flaring Tool
 - Metal case W230×D130×H35

Applicable

Pipe type	Size
Copper pipe	3/16•1/4•5/16•3/8•7/16•1/2•5/8

- This is a set of flaring tool and tube cutter necessary for flaring the connection of air conditioner piping.
- Flare angle is 90°.

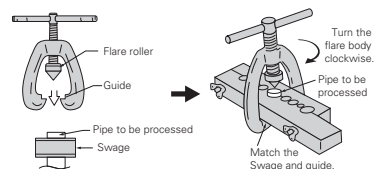

• Please read the "Instruction Manual" and other relevant documents carefully before use.

- Function mark is indicated under the product name. For the details, please refer to P.004-005.
- Products marked with ⚙️ should be ordered after checking stock.



FLANGING TOOL

Repair
Spare parts
Repairable

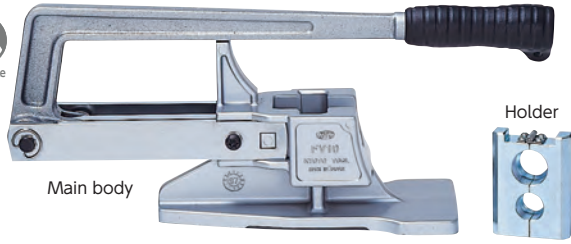

No.	L	W	H	Weight(kg)	⊞
FV10	350	90	145	3.7	1

- Tool for making seal faces for stainless steel flexible pipe connections for water and hot water supply.
- Stainless steel flexible pipes for water supply and hot water supply, Size 13, 20 (except spiral type)
- Just push down the handle for fast and efficient flange ejection.
- The constant force applied ensures even flange ejection at all times.
- One holder can accommodate two sizes of flexible pipes.
- The plastic case for storage.
- * Repair parts are available. Please contact our distributors for details.

Spare parts

No.	Description	Weight(g)
FV10-1	Holder	310



· Read the "Instruction Manual" carefully before use.

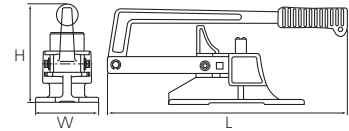

Usage rules

1 Set the flexible pipe in the holder.

Size 13 (1/2") Size 20 (3/4")

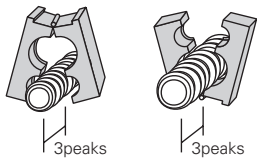

Place the flexible pipe in the hole of the holder that matches the size of the pipe, with three peaks out from the end face.

2 Attach the holder to the main body.

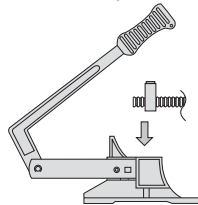

Attach the holder with the flexible tube set to the main unit.

3 Push down on the handle.

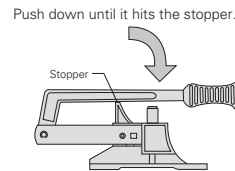

Push the handle down until it hits the stopper.

4 Remove the flexible tube from the main unit.

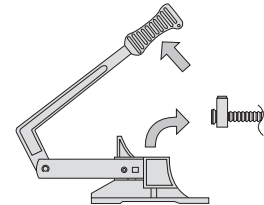

Raise the handle, pull out the entire holder, and remove the flexible pipe.

4 SIZE RATCHET BOX END WRENCH

18
12pt.
POWERFIT



No.	Size	D1	D2	T	L	Weight (g)	⊞
MR-0813	8×12·10×13	21	25	15	143	130	10
MR-1014	10×13·12×14	25	28	15	166	160	10

- Thin sockets for narrow space works.
- Eye-catching green color, and lightweight.
- Wave-shaped grip that fits the hand.

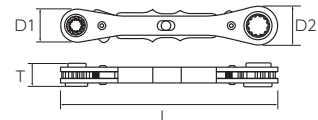

· To avoid damage, operate the left and right switching levers.
· For temporal tightening. Do not use for the final tightening.

4 SIZE RATCHET BOX END WRENCH (LONG)

18
12pt.
POWERFIT



No.	Size	h1	h2	h3	h4	D1	D2	T1	T2	L	Weight (g)	⊞
MR-0813L	8×12·10×13	10	17.5	15	17.5	21	25	34.5	44.5	143	180	10
MR-1014L	10×13·12×14	15	18	15	30	25	28	39.5	57.5	166	230	10

- Tightening of various electric lines and piping support materials.
- Long sockets allow work in deep locations.
- Eye-catching green color, and lightweight.
- Wave-shaped grip that fits the hand.

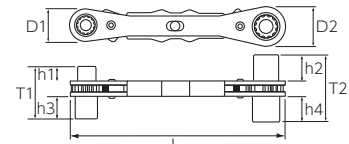

· To avoid damage, operate the left and right switching levers.
· For temporal tightening. Do not use for the final tightening.

· Do not hit or extend it with a pipe or other tools.

PIPE WRENCH



No.	Size	Maximum diameter of pipe that can be inserted	B	L	Weight (g)	☐	
PWA-150	150(6")	19	32	150	185	6	
PWA-200	200(8")	20	42.1	185	350	6	
PWA-250	250(10")	26	50.9	245	750	6	
PWA-300	300(12")	32	58	300	1,100	6	
PWA-350	350(14")	38	65.2	325	1,300	6	
PWA-450	450(18")	52	74.3	410	2,100	6	
PWA-600	600(24")	65	89.1	540	3,500	1	
PWA-900	900(36")	95	116.7	780	6,400	1	

• The teeth are heat-treated to ensure good bite.

* Repair parts are available. Please contact our distributors for details.

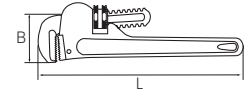

PIPE WRENCH (ALUMINIUM)



No.	Size	Maximum diameter of pipe that can be inserted	B	L	Weight (kg)	☐	
APWA-350	350(14")	38	65.7	325	1.0	6	
APWA-450	430(18")	52	74.8	400	1.6	2	
APWA-600	600(24")	65	90	550	2.5	2	

• The main body is made of aluminum alloy and is about 2/3 the weight of ordinary products.

* Repair parts are available. Please contact our distributors for details.

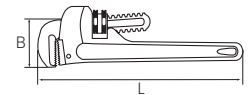

• Function mark is indicated under the product name. For the details, please refer to P.004-005.
 • Products marked with  should be ordered after checking stock.

